



ARTEK

GEAR MOTOR WITH ARTICULATED ARM FOR SWING GATES



INSTALLATION AND USE MANUAL

6-1624111 - rev. 0.0 - 15/09/2023

ENGLISH - Translated from the original language



INDEX

1. GENERAL WARNINGS FOR THE INSTALLER	3
2. RESIDENTIAL APPLICATION	4
3. TECHNICAL SPECIFICATIONS	5
4. UTILISATION LIMITS	5
5. OVERALL DIMENSIONS	5
6. FIXING AND ADJUSTMENT OF MECHANICAL STOPS FOR LIMIT SWITCHES	6
7. PRELIMINARY CHECK	7
8. BRACKETS FIXING ON THE COLUMN AND ON THE GATE (drowning 1 and drowning 2)	7
9. FIXING THE GEARED MOTOR	9
10. MOUNTING THE ARTICULATED ARM (Figures 5, 6, 7)	10
11. PRODUCT DISPOSAL	12
12. WARRANTY	12

WARNING

- This manual is for qualified technical personnel only for installation purposes and not intended for the end user; it's the installer's job to explain to the user how the automatism works, about possible hazards related to it and about the need for periodical maintenance.
- The automatism must be installed by qualified personnel only, observing current standards concerning automatic closing systems. More specifically, installation conformity calls for observance of directive 89/392 and standards EN 12453 and EN 12445.
- As ARTEK is made specifically to control swing gates it is forbidden to use the product for different purposes or improperly.
- Use original components only. ALLMATIC is not liable for damages if other components are used.
- Make certain that the gate structure is solid and suitable for being motor-driven.
- When the gate is moving make sure there are no points of friction and there is no chance of it derailing.
- Make absolutely certain the power is disconnected before carrying out any work on the device.
- Connect the power lead to supply lines with adequate electrical protection only; install a device to guarantee disconnection of all the phases from the mains that has a distance of at least 3.5 mm between the contacts.
- Pay particular attention when deciding which safety devices to install and their location. Always install an emergency stop device that will cut power off in the case of necessity.
- Only qualified personnel must be allowed to service the unit and access the internal parts of the geared motor.
- Irreversibility of the geared motors means an electric lock does not have to be installed and, in the case of black-out the release device (protected by a personalised key) lets you open the gate by hand. We do however recommend using an electric lock to ensure correct closing especially if the swing gates are longer than 2.5 metres.



2. RESIDENTIAL APPLICATION

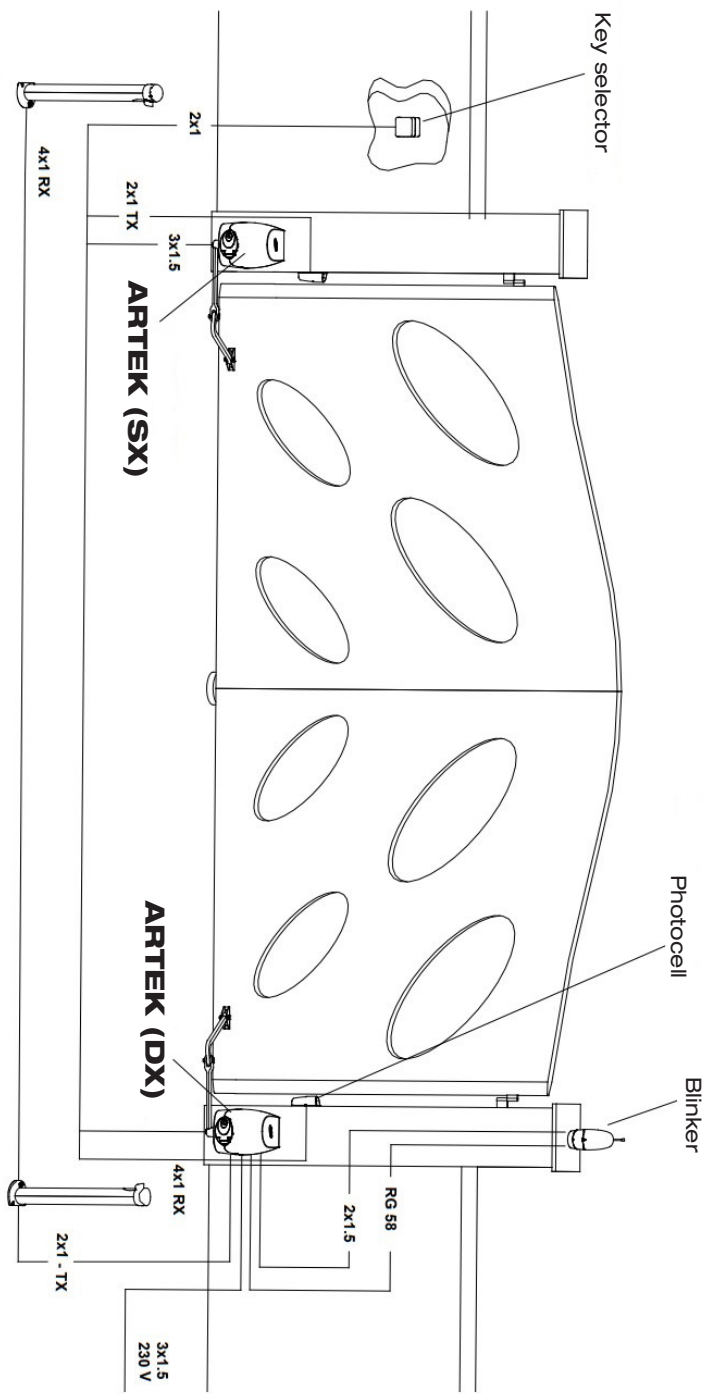

3. TECHNICAL SPECIFICATIONS

Commercial name	ARTEK 24V
Motor supply	24Vdc
Max. current requirement (A)	4
Max. motor power (W)	100
90° Travel time (sec.)	16 - 20
Torque (Nm)	160
Working temperature (°C)	-20 ... +60
Work cycle (%)	intensive
IP protection level	44
Weight (Kg)	10

4. UTILISATION LIMITS

LEAF	1 m	1,5 m	2 m	2,3 m
300 kg	•			
250 kg	•	•		
225 kg	•	•	•	
200 kg	•	•	•	•

5. OVERALL DIMENSIONS

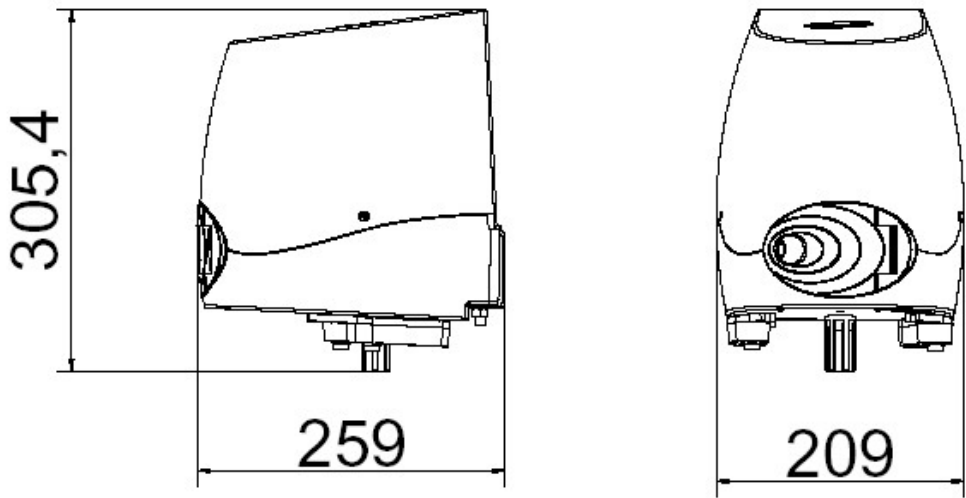

6. FIXING AND ADJUSTMENT OF MECHANICAL STOPS FOR LIMIT SWITCHES

If you want to use mechanical stops, they must be put on their own tracks on the lower part of the ARTEK motor. To adjust the stops, close the gate and slide the mechanical stop 1 until it is next to the motor arm. Fix now the stop using a hexagonal M8x30 screw (wrench N°13). To use the mechanical stop even in the opening phase, repeat the same operation on the mechanical stop 2 as described on the drawing below.

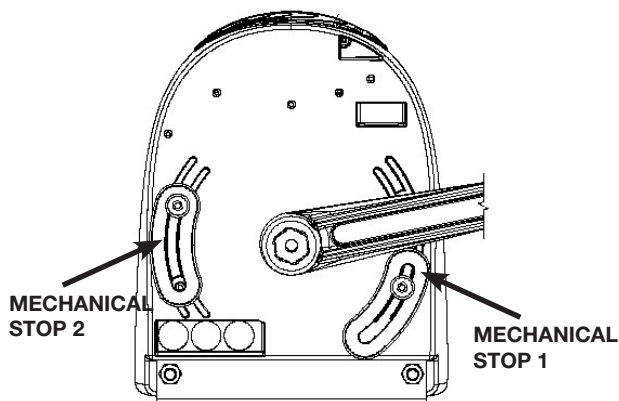

Adjustment of the mechanical stop 1 closing phase

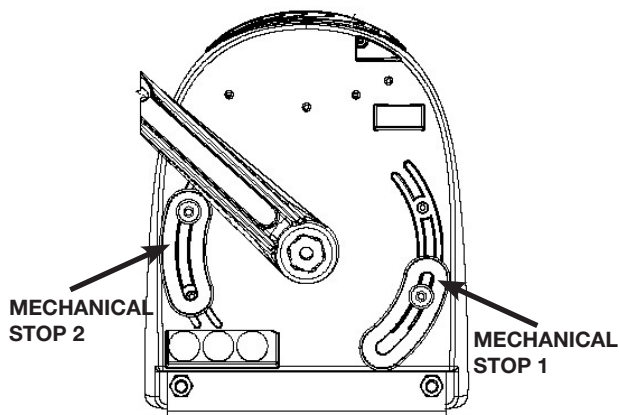
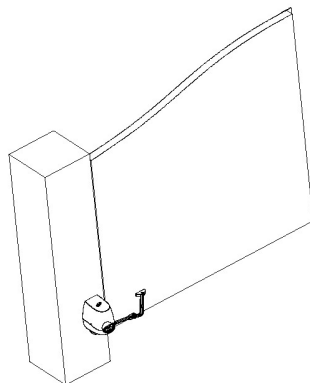

Adjustment of the mechanical stop 2 in opening phase

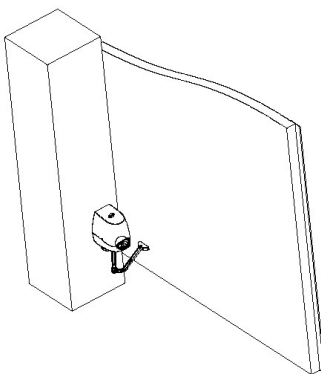

The drawing is referred to the opening and closing phase of the left wing. For the right one, the position of the two mechanical stops is inverted.

7. PRELIMINARY CHECK

Before installing the motor, check the topics below:

- Gate structure must be tough and there must not be any friction between the wing and its pivot.
- Gate pivots must work correctly and be lubricated enough.
- There must be a closing limit stop to avoid to overrun of the wing (if a mechanical stop is not used).

8. BRACKETS FIXING ON THE COLUMN AND ON THE GATE (drowning 1 and drowning 2)

Once you checked that the motor can be installed, fix the bracket plate on the column 100mm far from the ground (use Ø14 rawlplung and M8 screws); fix now the bracket plate on the wing (use M6 screws), following the quotes in the table 1 (if mechanical stops are not used) or in the table 2 (if mechanical stops are used).

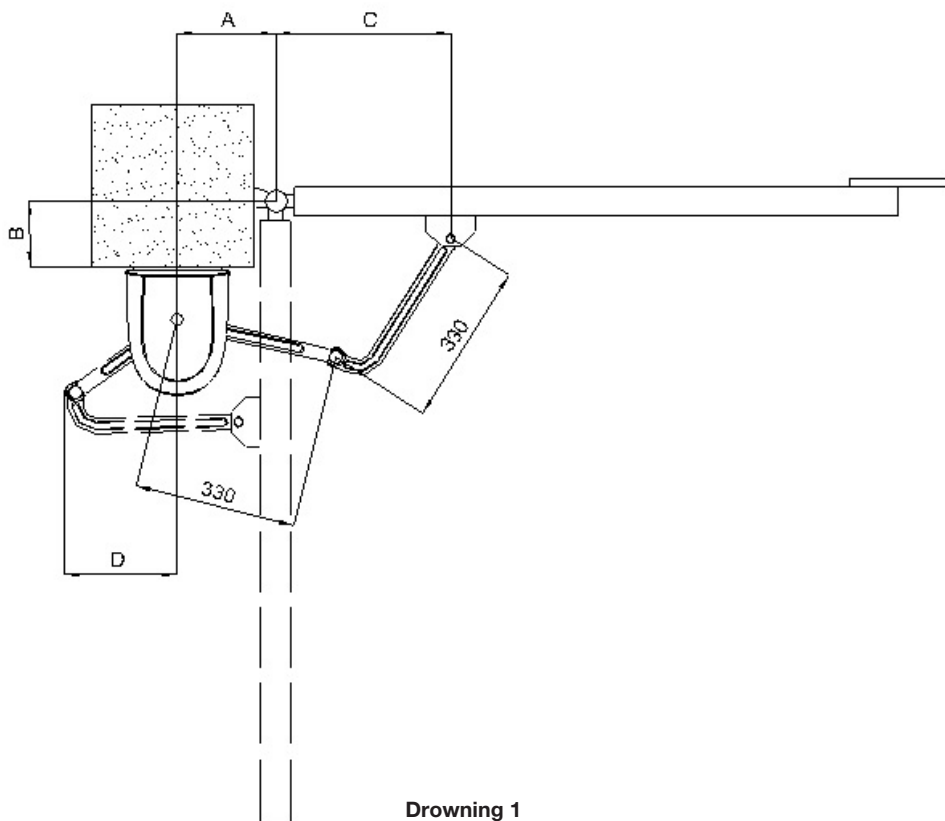

Drowning 1

OPENING	A	B	C	D
90°	155 ÷ 210	0	430	230 max
90°	155 ÷ 210	50	430	230 max
90°	155 ÷ 210	75	430	230 max
90°	155 ÷ 210	100	430	230 max
90°	155 ÷ 210	125	430	230 max
90°	155 ÷ 210	150	400	230 max
90°	155 ÷ 210	175	400	230 max
90°	155 ÷ 210	200	400	230 max
105°	190 ÷ 210	0	430	230 max
105°	200	30	430	230 max

Table 1 Installation quotes if mechanical stops are not used.

OPENING	A	B	C	D
90°	155	200	400	230 max
90°	155	175	400	230 max
90°	155 ÷ 210	150	400	230 max
90°	155 ÷ 210	125	400	230 max
90°	155 ÷ 210	100	400	230 max
90°	155 ÷ 210	75	400	230 max
90°	155 ÷ 210	50	400	230 max
90°	155 ÷ 210	200	400	230 max
105°	190 ÷ 210	0	430	230 max
105°	200	30	430	230 max

Table 2 Installation quotes if mechanical stops are used.

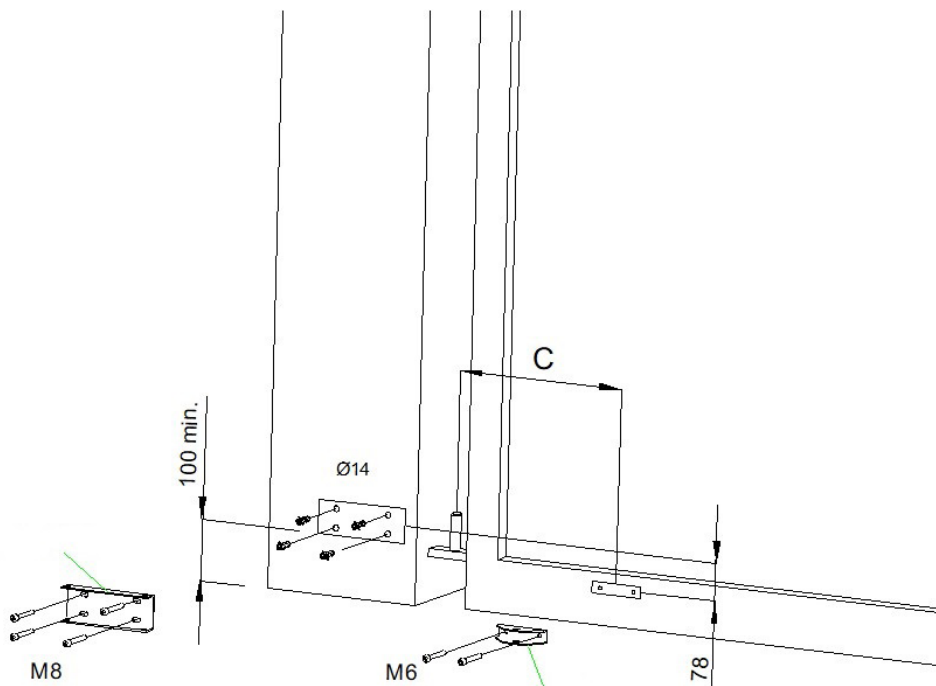

Drawing 2

9. FIXING THE GEARED MOTOR

Unscrew the 4.2x9.5 screws and remove the cover (Fig. 3).

Fit the geared motor on the base plate by the holes and lock it in place with the M8x90 screws and nuts (Fig. 4).

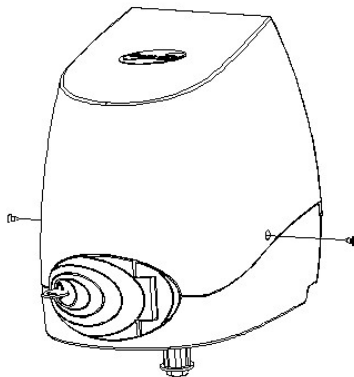

Drawing 3

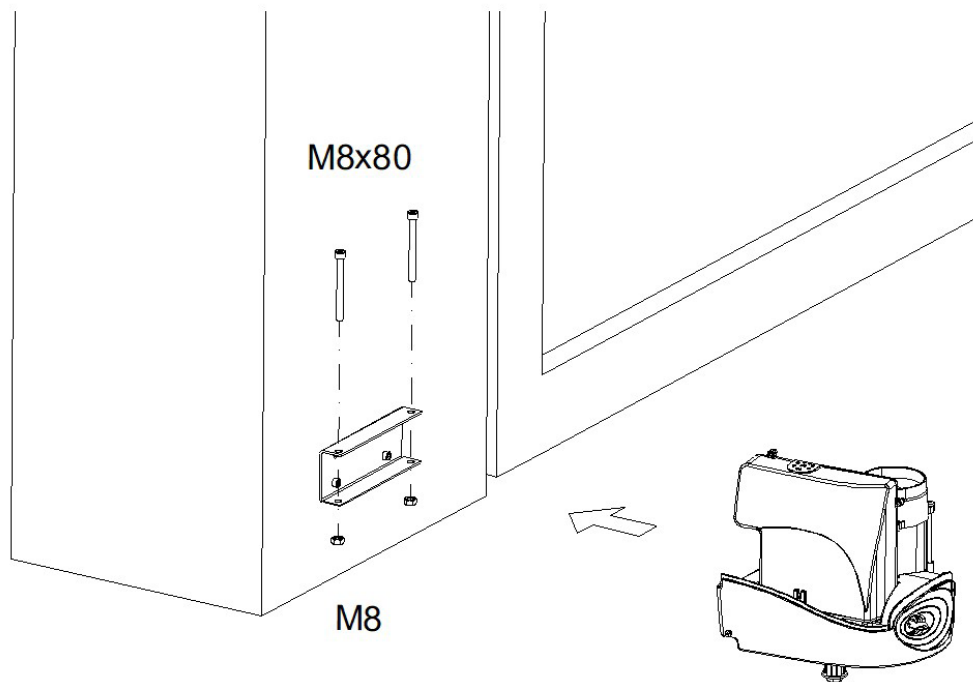

Drawing 4

10. MOUNTING THE ARTICULATED ARM (Figures 5, 6, 7)

1. The arm must be put in straight by the keyed shaft; position the 11 Ø x30 washer and lock the arm with the M10x28 screw.
2. Release the geared motor by turning the key clockwise, opening the door 90° and pulling the release knob.
3. Fit the bushing on the other end and lock the curved arm to the gate bracket with the M12x40 screw and M12 nut.

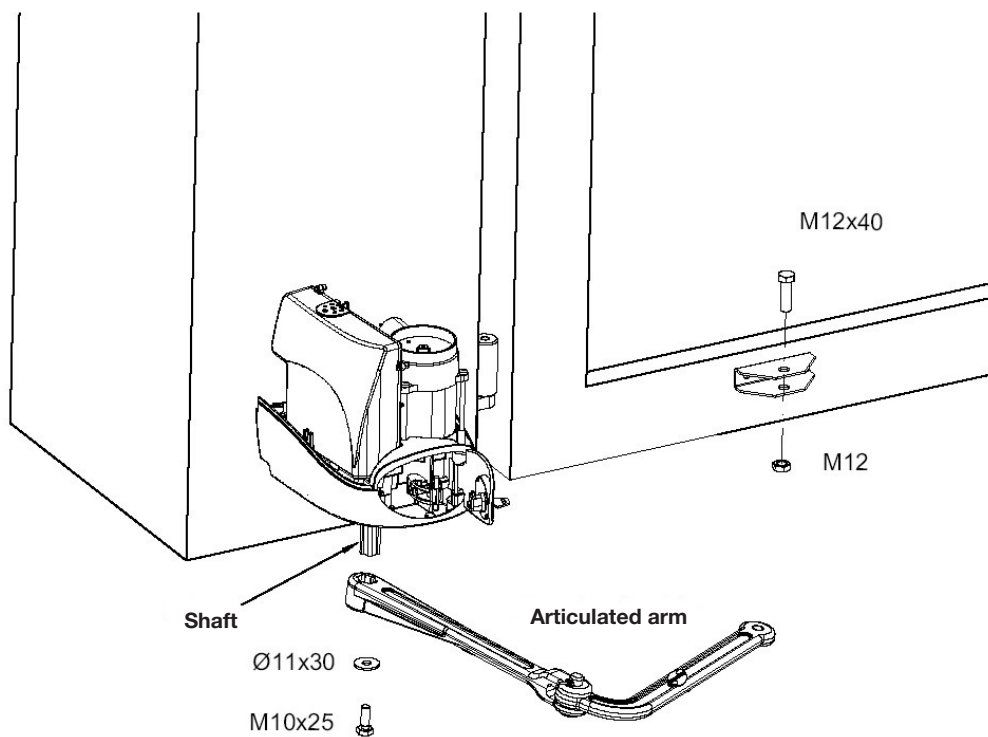

Drawing 5

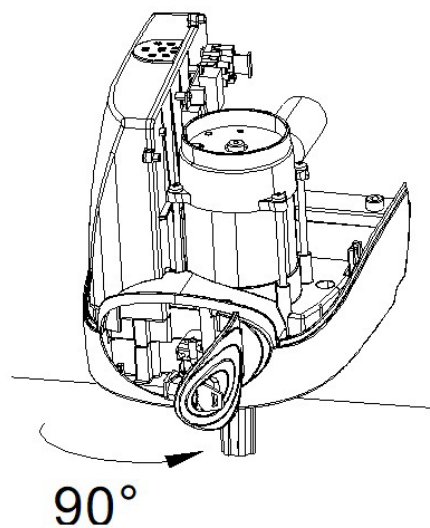

Drawing 6

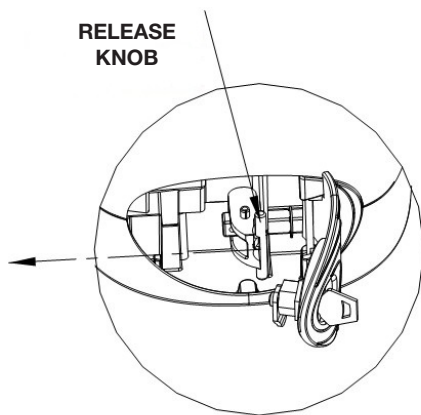

Drawing 7

11. PRODUCT DISPOSAL

As for installation operations, the disassembly of this product must be carried out by qualified personnel. The symbol on the side indicates that the product should not be disposed of as unsorted waste, but should be sent to separate collection facilities for recovery and recycling. For disposal check the recycling or disposal systems provided by the territorial regulations in force for this category of product, or return the product to the seller.

WARNING - • This product consists of various types of materials: some parts of the product may contain pollutants or dangerous substances that, if dispersed, could cause harmful effects to the environment and health. • Local regulations may provide for heavy penalties in the event of incorrect disposal of this product



12. WARRANTY

The manufacturer's warranty is valid by law from the date printed on the product and is limited to the free repair or replacement of parts recognized by the manufacturer as defective due to lack of essential qualities in the materials or for errors in the production process. The warranty does not cover damage or defects due to external agents, lack of maintenance, overload, normal wear, installation error, or other causes not attributable to the manufacturer. Tampered products will not be covered by warranty. The manufacturer is not responsible for malfunctions or degradation of performance due to environmental interference, such as electromagnetic disturbances; therefore, the warranty expires in these situations.



ALLMATIC S.r.l
32026 Borgo Valbelluna - Belluno – Italy
Via dell'Artigiano, n°1 – Z.A.
Tel. 0437 751175 – 751163 r.a. Fax 0437 751065
E-mail: info@allmatic.com
www.allmatic.com



/allmaticsrl



@allmaticsrl



@AllmaticSrl